



**ACME TOWNSHIP PARKS & TRAILS MEETING
ACME TOWNSHIP HALL
6042 Acme Road, Williamsburg MI 49690
Monday, November 18, 2019 4:00 p.m.**

ROLL CALL:

Committee:

| | | | | | |
|---------|---------|---|---------|---|-----------|
| x | Heflin | x | Heffner | x | Jenema |
| excused | Smith | x | Timmins | x | Wentzloff |
| excused | Kushman | x | Lamott | | |
| x | Wolf | x | Donn | | |

Advisory:

Staff:

A. PUBLIC COMMENT: Opened at 4:00 pm

Brian Kelley, Acme resident, thanked Ryan Lamott for all the work he has done on the parks.

B. APPROVAL OF AGENDA: Motion by Timmins to approve the agenda as presented with the addition to F. Old Business, 4. TART Trail Stakeholders Meeting, seconded by Wentzloff. Motion carries.

C. INQUIRY AS TO CONFLICTS OF INTEREST: None

D. CORRESPONDENCE: None

E. ACTION:

1. Approve Draft Parks & Trails Minutes 10.21.19

Motion by Timmins to approve the minutes of 10.21.19 as presented, seconded by Heflin. Motion carries.

F. OLD BUSINESS:

1. Art In The Park-Locations & Committee Updates

Jenema reported she went online and found a list of objectives for establishing a plan on displaying works of art in the township. She modified the list to fit the needs and added Smith's steps to have the committee review for a discussion at next month's meeting. The committee needs to look at the project goals for a recommendation to the board for the ordinance and be in the park's master plan.

2. Bayside Bottle Filler Quotes (Lamott)

Lamott presented a proposal from Sheren Plumbing on just installing a water bottle filler in the park. The quote sent was for adding a bottle filler to the existing drinking fountain. The committee agreed the old drinking fountain needs to be replaced and would like to see if they could get donations for a new one. Lamott is waiting for information from Sheren on the additional cost.

3. Bayside Playground Expansion

Wentzloff and Heffner went to the Traverse City Civic Center to look at the playground equipment and are working on a list of items they felt would be good to have for Bayside Park. Wentzloff looked through the LSI brochure on playground equipment and suggested telling them what is wanted and have them create a design for the park. She would like to see what equipment kids are playing on and like the most. The committee would like to see what can be attached to the already existing net climber and have pieces for all ages. Other things to consider are items for the handicap and disabled. The equipment needs to have a natural look, not constrict the view of the bay and to be placed with a concentration on the south end of the park.

Heffner brought up the old playground equipment and the committee all agreed it needs to remain. He and Wentzloff will keep working on researching the project with considerations of equipment for all ages.

Jenema said she would look up the contact for LSI to give them a copy of the site plan of the park to see what they would recommend on the equipment. The committee will need to work on donations for the project.

4. TART Trail Stakeholders Meeting

Wolf informed there is a Stakeholders meeting on the TART trail 75% completion, Tuesday, November 26 at noon in the township hall.

Jenema stated the primarily scoring for the \$300,000 grant came back and it was 335 points which is the highest that the township could receive. She went over the current grants that have been applied for to cover the costs of the TART Trail, \$300,000 DNR Grant, \$300,000 Iron Bell, \$75,000 from the Township, donation from the Cycling Club and TART will be working on the rest needed. They should know in December if the DNR grant will be awarded.

G. NEW BUSINESS:

1. Health Department of Northwest Michigan Grant RFP

Wolf stated she received a letter from the Health Department of Northwest Michigan to submit a proposal for a grant up to \$10,000 through the Building Healthy Spaces Greenspace Improvement Project funding. The funding is to encourage physical activity in the township but can't be used for playground equipment. It can be utilized for signs in the park and other projects. The Health Department has a Come out and Play or Walk Michigan program that they will help implement. Someone representing the township would need to take part in the program. In the RFP to apply they must include what type of program would be made available by the township and if any other grants may be obtained.

Wentzloff said signage is hard to get donated and the funding from the grant would be good for covering those costs.

Jenema said a motion would be needed to have the board approve for submittal of the application for the grant.

Wolf explained depending on costs, the grant could be used for more than one project and with the application a sheet of line items needed will be sent. The deadline date to send the letter of intent for the grant, is Decembers 13 after next month's board meeting.

Motion by Wentzoff recommending to the board to support the application for the Health Department of Northwest Michigan grant for signage and other infrastructures at Bayside Park, seconded by Heflin. Motion carries.

H. PUBLIC COMMENT: None

ADJOURN: Motion by Timmins to adjourn, seconded by Heflin. Meeting adjourned at 4:52 pm



ACME TOWNSHIP PARKS & TRAILS MEETING
ACME TOWNSHIP HALL
6042 Acme Road, Williamsburg MI 49690
March 16, 2020 4:00 p.m.

ROLL CALL:

Committee:

| | | | | | | | |
|--|---------|--|---------|--|-----------|--|--|
| | Heflin | | Heffner | | Jenema | | |
| | Vacancy | | Timmins | | Wentzloff | | |
| | Kushman | | Lamott | | | | |
| | Wolf | | Donn | | | | |

Advisory:

Staff:

- A. PUBLIC COMMENT:**
- B. APPROVAL OF AGENDA:**
- C. INQUIRY AS TO CONFLICTS OF INTEREST:**
- D. CORRESPONDENCE:**
- E. ACTION:**
 - 1. Approve Draft Parks & Trails Minutes 11.18.19
- F. OLD BUSINESS:**
 - 1. Bayside Playground Expansion
- G. NEW BUSINESS:**
 - 1. TART Update – TC CHX Trail
 - 2. Parks Ordinance: Bayside restrictions
 - 3. AARP Grant Application
- H. PUBLIC COMMENT**

ADJOURN:



ACME TOWNSHIP PARKS & TRAILS MEETING
ACME TOWNSHIP HALL
6042 Acme Road, Williamsburg MI 49690
Monday, November 18, 2019 4:00 p.m.

ROLL CALL:

Committee:

| | | | | | |
|---------|---------|---|---------|---|-----------|
| x | Heflin | x | Heffner | x | Jenema |
| excused | Smith | x | Timmins | x | Wentzloff |
| excused | Kushman | x | Lamott | | |
| x | Wolf | x | Donn | | |

Advisory:

Staff:

A. PUBLIC COMMENT: Opened at 4:00 pm

Brian Kelley, Acme resident, thanked Ryan Lamott for all the work he has done on the parks.

B. APPROVAL OF AGENDA: Motion by Timmins to approve the agenda as presented with the addition to F. Old Business, 4. TART Trail Stakeholders Meeting, seconded by Wentzloff. Motion carries.

C. INQUIRY AS TO CONFLICTS OF INTEREST: None

D. CORRESPONDENCE: None

E. ACTION:

1. Approve Draft Parks & Trails Minutes 10.21.19

Motion by Timmins to approve the minutes of 10.21.19 as presented, seconded by Heflin. Motion carries.

F. OLD BUSINESS:

1. Art In The Park-Locations & Committee Updates

Jenema reported she went online and found a list of objectives for establishing a plan on displaying works of art in the township. She modified the list to fit the needs and added Smith's steps to have the committee review for a discussion at next month's meeting. The committee needs to look at the project goals for a recommendation to the board for the ordinance and be in the park's master plan.

2. Bayside Bottle Filler Quotes (Lamott)

Lamott presented a proposal from Sheren Plumbing on just installing a water bottle filler in the park. The quote sent was for adding a bottle filler to the existing drinking fountain. The committee agreed the old drinking fountain needs to be replaced and would like to see if they could get donations for a new one. Lamott is waiting for information from Sheren on the additional cost.

3. Bayside Playground Expansion

Wentzloff and Heffner went to the Traverse City Civic Center to look at the playground equipment and are working on a list of items they felt would be good to have for Bayside Park. Wentzloff looked through the LSI brochure on playground equipment and suggested telling them what is wanted and have them create a design for the park. She would like to see what equipment kids are playing on and like the most. The committee would like to see what can be attached to the already existing net climber and have pieces for all ages. Other things to consider are items for the handicap and disabled. The equipment needs to have a natural look, not constrict the view of the bay and to be placed with a concentration on the south end of the park.

Heffner brought up the old playground equipment and the committee all agreed it needs to remain. He and Wentzloff will keep working on researching the project with considerations of equipment for all ages.

Jenema said she would look up the contact for LSI to give them a copy of the site plan of the park to see what they would recommend on the equipment. The committee will need to work on donations for the project.

4. TART Trail Stakeholders Meeting

Wolf informed there is a Stakeholders meeting on the TART trail 75% completion, Tuesday, November 26 at noon in the township hall.

Jenema stated the primarily scoring for the \$300,000 grant came back and it was 335 points which is the highest that the township could receive. She went over the current grants that have been applied for to cover the costs of the TART Trail, \$300,000 DNR Grant, \$300,000 Iron Bell, \$75,000 from the Township, donation from the Cycling Club and TART will be working on the rest needed. They should know in December if the DNR grant will be awarded.

G. NEW BUSINESS:

1. Health Department of Northwest Michigan Grant RFP

Wolf stated she received a letter from the Health Department of Northwest Michigan to submit a proposal for a grant up to \$10,000 through the Building Healthy Spaces Greenspace Improvement Project funding. The funding is to encourage physical activity in the township but can't be used for playground equipment. It can be utilized for signs in the park and other projects. The Health Department has a Come out and Play or Walk Michigan program that they will help implement. Someone representing the township would need to take part in the program. In the RFP to apply they must include what type of program would be made available by the township and if any other grants may be obtained.

Wentzloff said signage is hard to get donated and the funding from the grant would be good for covering those costs.

Jenema said a motion would be needed to have the board approve for submittal of the application for the grant.

Wolf explained depending on costs, the grant could be used for more than one project and with the application a sheet of line items needed will be sent. The deadline date to send the letter of intent for the grant, is Decembers 13 after next month's board meeting.

Motion by Wentzoff recommending to the board to support the application for the Health Department of Northwest Michigan grant for signage and other infrastructures at Bayside Park, seconded by Heflin. Motion carries.

H. PUBLIC COMMENT: None

ADJOURN: Motion by Timmins to adjourn, seconded by Heflin. Meeting adjourned at 4:52 pm



Rendered in Shine Palette



Acme Township North Bayside Park



Rendered in Shine Palette



Acme Township North Bayside Park

Pieces to go into PIP

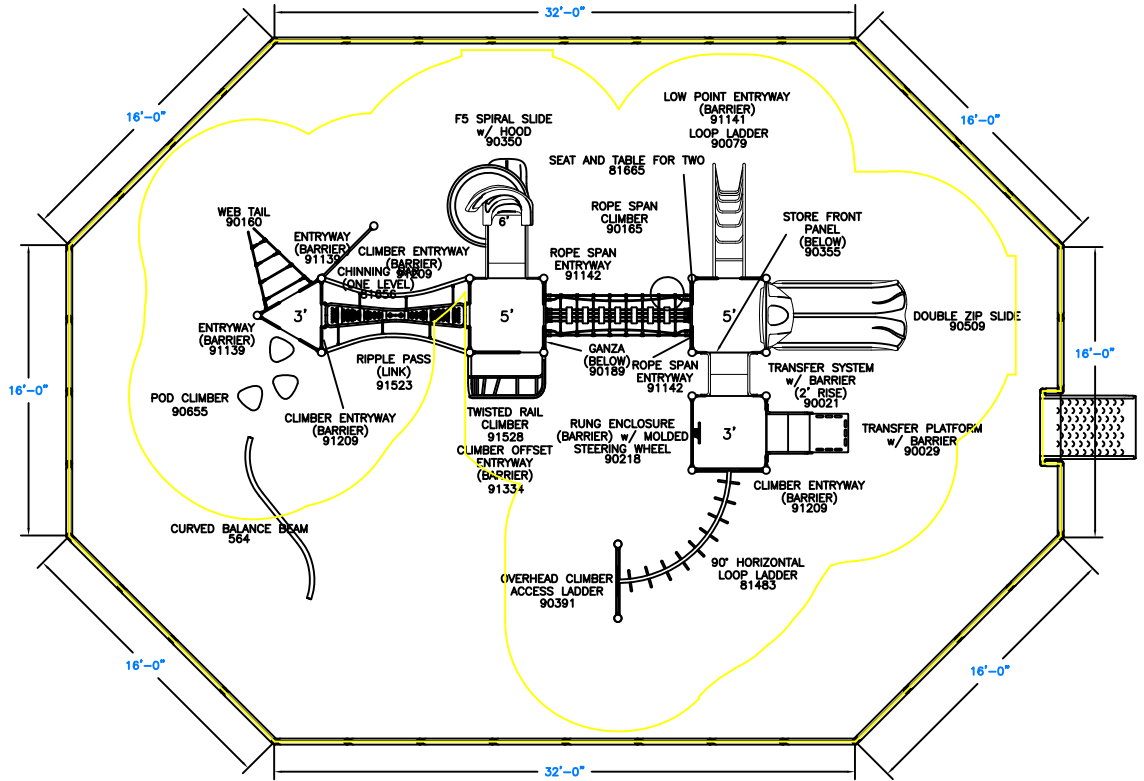
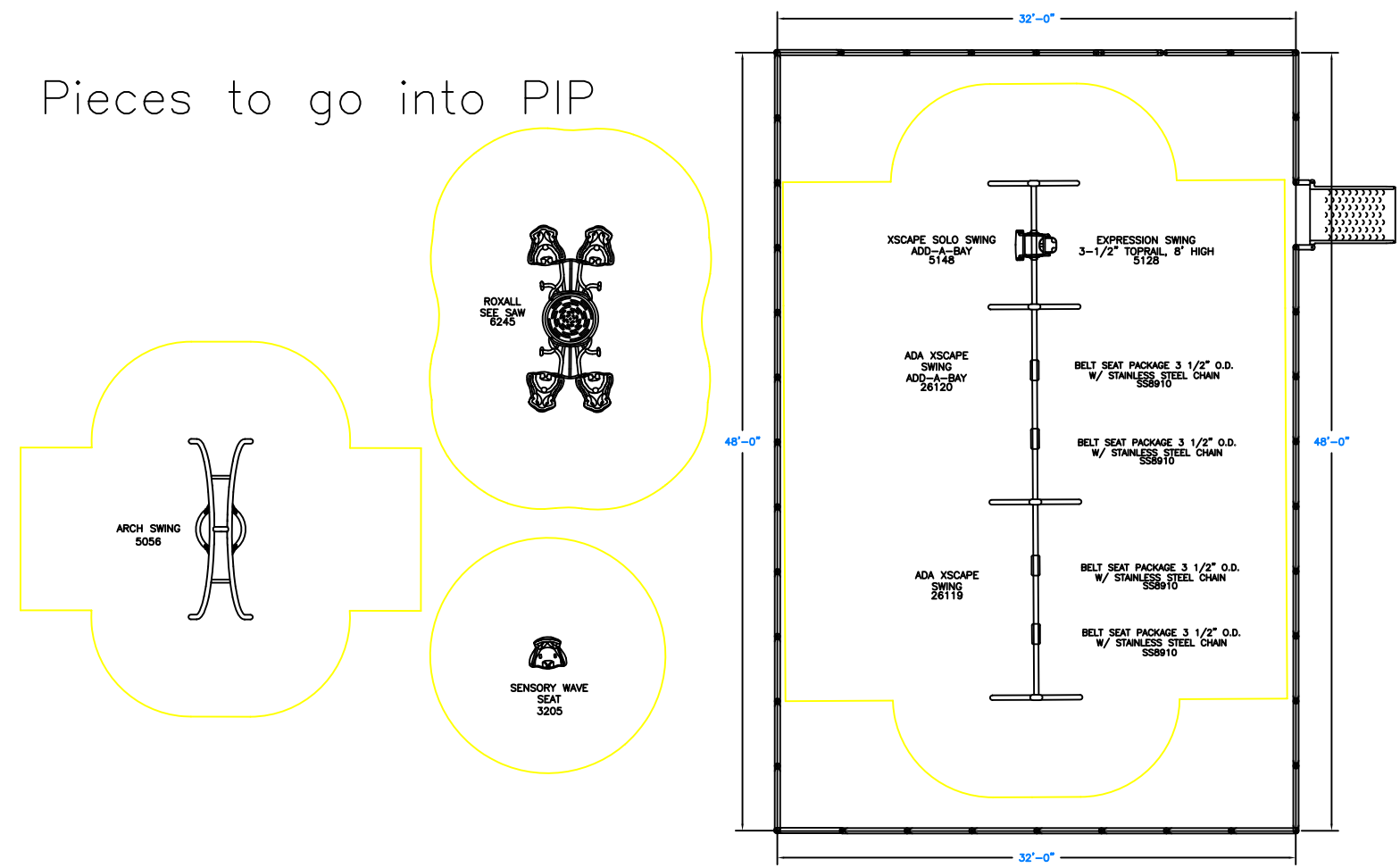

150 PlayCore Drive SE
Fort Payne, AL 35967
www.gametime.com

Acme Township
 Williamsburg, MI
 Representative
Sinclair Recreation

This Unit includes play events and routes or travel specifically designed for special needs users. It is the opinion of the manufacturer that these play events and routes of travel conform to the accessibility requirements of the ADA (Americans with Disabilities Act)

| | | | |
|---|----|----------|---|
| Total Elevated Play Components | 10 | Required | - |
| Total Elevated Play Components Accessible By Ramp | - | Required | - |
| Total Elevated Components Accessible By Transfer | 5 | Required | 5 |
| Total Accessible Ground Level Components Shown | 5 | Required | 3 |
| Total Different Types Of Ground Level Components | 4 | Required | 3 |

This play equipment is recommended for children ages
5 - 12

Minimum Area Required:
 Scale: 1" = 5'-0"
 This drawing can be scaled only when in an 24" x 36" format

IMPORTANT: Soft resilient surfacing should be placed in the use zones of all equipment, as specified for each type of equipment, and at depths to meet the critical fall heights as specified by the U.S. consumer Product Safety Commission, ASTM standard F 1487 and Canadian Standard CAN/CSA-Z614

Drawn By:
 JLL
 Date:
 02/17/2020
 Drawing Name:
 Acme Township 2020

Proposed Layout — Subject to change based on onsite measurements. Must be confirmed prior to installation. Please note a new configuration of the area and equipment could effect the cost of Poured-In-Place (PIP) Surfacing.

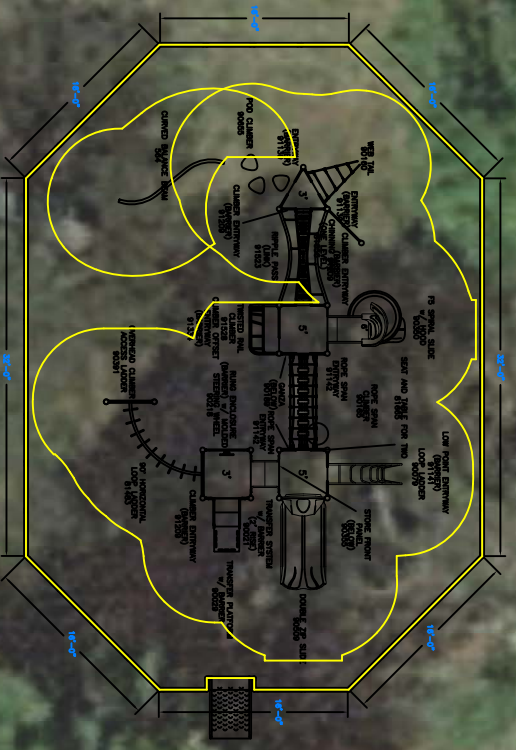
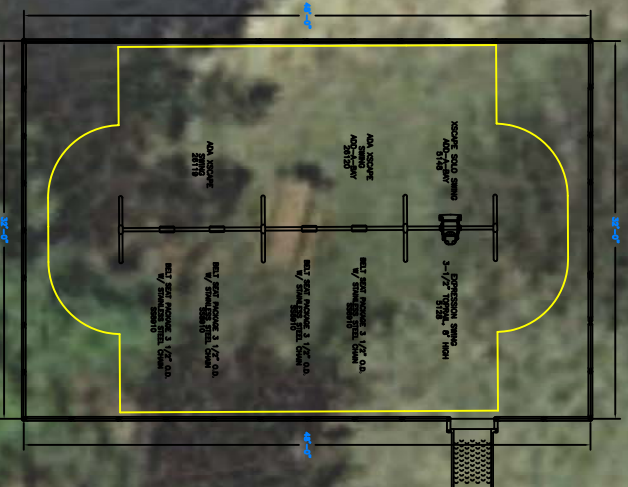



GameTime c/o Sinclair Recreation
 PO Box 1409
 Holland, MI 49422-1409
 Ph: 800-444-4954
 Fax: 616-392-8634

02/17/2020
 Quote #100055-01-01

North Bayside Park - Playground Area

ACME TOWNSHIP HALL
 Attn: Jim Heffner
 6042 ACME RD
 WILLIAMSBURG, MI 49690-9445
 jhefgan@yahoo.com

Ship to Zip 49610

| Quantity | Part # | Description | Unit Price | Amount |
|----------|--------|---|-------------|-------------|
| 1 | RDU | GameTime - Custom PowerScope Structure | \$52,125.00 | \$52,125.00 |
| | | (1) 90189 -- Ganza Panel | | |
| | | (1) 81665 -- Seat And Table For Two | | |
| | | (1) 90355 -- Storefront Panel, Below Dk | | |
| | | (1) 81656 -- 1-Level Chin Bar | | |
| | | (1) 564 -- Curved Balance Beam | | |
| | | (1) 90029 -- 3' Transfer Platform W/Barrier | | |
| | | (3) 91209 -- Climber Entryway - Barrier | | |
| | | (1) 90391 -- 3'-0" Overhead Climber Access Ladder | | |
| | | (1) 81483 -- 90 Deg Loop Ladder Link | | |
| | | (1) 90218 -- Rung Encl Mold S. Whl & Bar,Above Dk | | |
| | | (3) 80000 -- 49" Sq Punched Steel Deck | | |
| | | (2) 91139 -- Entryway - Barrier | | |
| | | (1) 90160 -- 3'/5' Web Tail | | |
| | | (1) 90655 -- Pod Climber | | |
| | | (1) 80001 -- 49"Tri Punched Steel Deck | | |
| | | (1) 91334 -- Climber Offset Entryway (Barrier) | | |
| | | (1) 91528 -- Twisted Rail Climber 4'/5' | | |
| | | (2) 91142 -- Rope Span Entryway - Barrier | | |
| | | (1) 91141 -- Low Point Entryway - Barrier | | |
| | | (1) 90079 -- 5' Loop Ladder | | |
| | | (1) 90509 -- 5' Double Zip Slide, Std Dk | | |
| | | (1) 90350 -- 5'-0 F5 Slide W/Hood | | |
| | | (1) 91523 -- Ripple Pass | | |
| | | (1) 90021 -- 2'-0" Transfer System W/ Barrier | | |
| | | (1) 90165 -- 2'/5' Rope Span Climber | | |
| | | (6) G90269 -- 11' Upright, Galv | | |
| | | (6) 90269 -- 11' Upright, Alum | | |
| | | (2) 90268 -- 10' Upright, Alum | | |
| | | (1) 90267 -- 9' Upright, Alum | | |
| | | (2) G90267 -- 9' Upright, Galv | | |





GameTime c/o Sinclair Recreation
 PO Box 1409
 Holland, MI 49422-1409
 Ph: 800-444-4954
 Fax: 616-392-8634

02/17/2020
 Quote #100055-01-01

North Bayside Park - Playground Area

| Quantity | Part # | Description | Unit Price | Amount |
|----------|-----------------------------|---|------------------|---------------------|
| | | (1) G90265 -- 7' Upright, Galv | | |
| 1 | RDU | GameTime - XScape Swings with Seats | \$5,588.00 | \$5,588.00 |
| | | (4) SS8910 -- Belt Seat 3 1/2" /8' W/Clevis | | |
| | | (1) 5128 -- Expression Swing 3 1/2" X 8' | | |
| | | (1) 5148 -- Xscape Swing Aab 3 1/2" X 8' | | |
| | | (1) 26120 -- Ada Xscape Swing Add-A-Bay | | |
| | | (1) 26119 -- Ada Xscape Swing | | |
| 1 | 5056 | GameTime - Arch Swing | \$6,481.00 | \$6,481.00 |
| 1 | 6245 | GameTime - RoxAll See Saw | \$10,514.00 | \$10,514.00 |
| 1 | 3205 | GameTime - Spinning Sensory Wave Seat | \$1,132.00 | \$1,132.00 |
| 1 | RDU | GameTime - Playground Borders and Accessible Curbs for Swings and Structure | \$5,328.00 | \$5,328.00 |
| | | (1) 4858 -- Access Playcurb-W/Adap | | |
| | | (78) 4862 -- 12" Playground Border | | |
| | | (1) 4854 -- Accessible Playcurb | | |
| | | (2) 4853 -- Playcurb Adapter-R | | |
| 9 | 161292 | GameTime - Wear Mat 44"x48" | \$239.00 | \$2,151.00 |
| 3500 | EWF (Engineered Wood Fiber) | GT-Impax - EWF Safety Surfacing 12" Deep | \$1.50 | \$5,250.00 |
| 1920 | PIP (Poured-In-Place) | GT-Impax - PIP Safety Surfacing - 8' CFH 3.5" Thick 50/50 Color/Black - Includes turned down edge and crushed stone subbase. Does not include excavation or site prep. For dumpster please add \$810.00 For site security please add \$450.00 | \$19.45 | \$37,344.00 |
| 2 | 161290 | GameTime - Geo-Textile 2250 Sqft Roll | \$681.00 | \$1,362.00 |
| 1920 | Excavation | Sinclair Recreation - Excavation (removal and disposal) for play areas - Includes removal and disposal of spoils. - 4" Deep | \$2.50 | \$4,800.00 |
| 1 | INSTALL | Installation - Installation of Structure, Swings, Freestanding, Curbs, EWF, and Mats- Does not include acceptance of delivery, unloading of equipment, or storage of equipment | \$26,750.00 | \$26,750.00 |
| | | | Sub Total | \$158,825.00 |
| | | | Discount | (\$13,031.25) |
| | | | Freight | \$5,006.62 |
| | | | Total | \$150,800.37 |





GameTime c/o Sinclair Recreation
 PO Box 1409
 Holland, MI 49422-1409
 Ph: 800-444-4954
 Fax: 616-392-8634

02/17/2020
 Quote #100055-01-01

North Bayside Park - Playground Area

This quotation is subject to policies in the current GameTime Playground Catalog and the following terms and conditions. Our quotation is based on shipment of all items at one time to a single destination, unless noted, and changes are subject to price adjustment. Purchases to be supported by your written purchase order made out to GAMETIME C/O SINCLAIR RECREATION.

NOTE: PRICING DOES NOT INCLUDE ANY DAVIS BACON OR PREVAILING WAGE RATES UNLESS SPECIFICALLY IDENTIFIED ABOVE IN QUOTE.

Pricing: f.o.b. factory, firm for 30 days from date of quotation unless otherwise noted on quotation. Sales tax will be added at time of invoicing unless a tax exemption certificate is provided at time of order entry.

Payment Terms: Payment in full, net 30 days subject to approval by GameTime Credit Manager. A 1.5% per month finance charge will be imposed on all past-due accounts. Equipment shall be invoiced separately from other services and shall be payable in advance of those services and project completion. Retainage not accepted.

Payment terms: Payment in full, check submitted with order.

Installation: Shall be by a Certified GameTime Installer. Customer shall be responsible for scheduling coordination and site preparation. Site should be level and permit installation equipment access. Purchaser shall be responsible for unknown conditions such as buried utilities, tree stumps, bedrock or any concealed materials or conditions that may result in additional labor or material costs. Payment terms for installation is Net 10 Days.

NOTE: PRICING DOES NOT INCLUDE ANY DAVIS BACON OR PREVAILING WAGE RATES UNLESS SPECIFICALLY IDENTIFIED ABOVE IN QUOTE. THERE WILL BE A BACKCHARGE FOR THE INSTALLATION TO BE DONE THROUGH FELT, PEASTONE, SURFACING, OR WOODCHIPS, UNLESS SPECIFICALLY LISTED IN ABOVE QUOTE.

Exclusions: Unless specifically included, this quotation excludes all site work and landscaping; removal of existing equipment; acceptance of equipment and off-loading; storage of goods prior to installation; equipment assembly and installation; safety surfacing; borders and drainage provisions.





GameTime c/o Sinclair Recreation
PO Box 1409
Holland, MI 49422-1409
Ph: 800-444-4954
Fax: 616-392-8634

02/17/2020
Quote #100055-01-01

North Bayside Park - Playground Area

Acceptance of quotation:

Accepted By (printed): _____

P.O. No: _____

Please make P.O.s out to GameTime C/O Sinclair Recreation

Signature: _____

Title: _____

Date: _____

Facsimile: _____

Phone: _____

Email: _____

Purchase Amount: \$150,800.37

REQUIRED ORDER INFORMATION:

Bill To: _____

Ship To: _____

Contact: _____

Contact: _____

Address: _____

Address: _____

Address: _____

Address: _____

City, State, Zip: _____

City, State, Zip: _____

Tel: _____

Tel: _____

(For Accounts Payable)

(To call before delivery)

Email: _____

Email: _____

COLOR SELECTIONS: _____

SALES TAX EXEMPTION CERTIFICATE #: _____ (PLEASE PROVIDE A COPY OF CERTIFICATE)

NOTE: PRICING DOES NOT INCLUDE ANY DAVIS BACON OR PREVAILING WAGE RATES UNLESS SPECIFICALLY IDENTIFIED ABOVE IN QUOTE. IF INSTALLATION IS BEING QUOTED, THERE WILL BE A BACKCHARGE FOR THE INSTALLATION TO BE DONE THROUGH FELT, PEASTONE, SURFACING, OR WOODCHIPS. PRICING VALID FOR 30 DAYS FROM THE DATE OF QUOTATION UNLESS OTHERWISE NOTED.

Quote prepared by: Jamie Lehman



ACME TOWNSHIP
ORDINANCE NO. 50 OF 2019

ACME TOWNSHIP PARKS ORDINANCE

THE TOWNSHIP OF ACME ORDAINS:

SECTION 1. Purpose of this Ordinance

The purposes of this ordinance are:

To protect the health, safety and welfare of visitors to the Township's parks.

To protect the health, safety and welfare of residents living near the parks.

To meet the Township's responsibility as the trustee of assets held for the present and future benefit of the public.

SECTION 2. Definitions as Used in this Ordinance:

"Facility" means any building, sign, structure, equipment, utility or other improvement in or on any park.

"Park" means any land or facility of any size or shape, including but not limited to linear ways, road ends, and submerged lands, owned by or under the full or partial control of Acme Township, that is used for recreation or held for future recreational use. Parks include areas within the riparian extensions of park boundary lines.

"Paths" means Paths 1, 2, 3 and 4, and Border Avenue, as depicted in the Plat of Woodland Acres. The paths include the beaches within the path boundary lines and the areas within the riparian extensions of those lines. (*See attached map.*)

"Personal Property" includes kayaks, kiteboards, paddleboards, boats, canoes, and other watercraft, beach chairs, hammocks and sun umbrellas as well as trailers, recreational vehicles, camping equipment or similar equipment used within a park.

"Recreation" includes picnicking, swimming, beach activities, hiking, boating, sports, lounging, photography, nature activities, fishing, and similar pursuits.

"Woodland Acres" means the subdivision platted in 1924 from a portion of Fractional Lot 3, and the SW 1/4 of the SE 1/4 and all of Fractional Lot 4, in Sec. 27, T 29 N, R 10 W, Acme Township, Grand Traverse County Michigan.

"Trail" means a path or narrow transportation-oriented corridor for the primary purpose of

biking, running, walking, or other non-motorized use. It may be of impervious surface, or other types of natural material, or may be left in its natural state. Trails usually have a beginning and ending point and have at least one trailhead.

SECTION 3. General Use Restrictions

All Township, State and Federal ordinances apply within the parks.

The following use restrictions shall be observed in all parks:

Hours. No person may be in a park from 30 minutes after sunset to 30 minutes before sunrise. Road ends and boat launches are open for launching and recovering boats 24 hours per day, and for swimming and wading in designated areas from 30 minutes before sunrise to 30 minutes after sunset.

Trespass. Users of the parks shall not trespass on adjacent property.

Litter. Littering in the parks or adjacent property is prohibited.

Vandalism. Vandalism or destruction of any public or private property is prohibited, including the cutting or removal of live vegetation or alteration of any surfaces.

Commercial and Vending Activities. Commercial and vending activities are not allowed. See ordinance #2016-02, as amended.

Hunting. Hunting is prohibited in all parkland areas other than Yuba Creek Natural Area. Hunting activities at Yuba Creek Natural Area must be in compliance with Michigan DNR regulations and may not include baiting of game.

Fires. Fires are prohibited in all parks except in designated and posted locations. Any fires for cooking must be made within the stoves or grills provided for that purpose or within other privately owned grills which are designed to retain the ashes and prevent their deposit upon the ground

Camping. Camping and overnight parking are prohibited in all parks.

Fireworks. Fireworks are prohibited in all parks. See Ordinance # 2016-01, as amended.

Storage. Storage of personal property is allowed only during designated park hours. No overnight storage is allowed.

Glass. Glass containers are prohibited within the areas of any park, including any water area, used for swimming or beach purposes.

Alcohol. No person may be intoxicated in any park.

Noise and conduct. Any activities or operation of equipment that disturbs the quiet, safety, comfort or repose of a reasonable person of normal sensitivities is prohibited. Any creation of a disturbance by obscene or disorderly conduct is prohibited.

Pets. Dogs and other pets are permitted within parks. All pets must be on a leash no longer than six feet and under the control of a responsible individual. The owner of any pet is responsible for cleaning up all solid waste left by the pet. No pets are allowed in designated swimming areas.

Motor vehicles. No person may operate any motorized vehicle in any park except where designated and posted. No person may operate a motorized vehicle in excess of 15 miles per hour in any park, except where designated and posted. Drivers of motorized vehicles shall obey all posted traffic control signs and devices. This section does not prohibit motorized wheelchairs and similar devices.

No person may park any motorized vehicle in any Park except where designated and posted. No motorized vehicle may be parked or left in any Park at times during which the Park is closed to the public. No motorized vehicle may be parked in any Park except for purposes directly related to use of said Park. The Township may post signs setting out parking regulations in any Park in which the Township determines a sign is necessary. The Township may also post signs stating that a motorized vehicle in violation may be towed and informing the vehicle's owner of the towing company's contact information.

Boats. Trailered boats shall only be launched from designated and posted launching sites. This section does not restrict the launching of kayaks, canoes and similar watercraft.

SECTION 3B. Park Specific Rules

1. Special Use Restrictions for the Paths in Woodland Acres

The paths in the Woodland Acres subdivision run into Grand Traverse Bay. The paths were dedicated to the public in 1924 with the intent and purpose of their use by residents in the neighborhood. The paths are public property under the jurisdiction and control of Acme Township. The general use restrictions in Section 3 of this ordinance shall apply to the paths, except as modified by the following special use restrictions shall be observed on the paths and their riparian extensions:

Hours. The paths may be used 24 hours per day.

Quiet hours. All persons shall observe quiet hours on the paths between the hours of 11 p.m to 7 a.m. Quiet hours shall mean any noise must be kept no louder than normal conversation.

Swimming. Swimming and wading are allowed on the paths.

Motor vehicles. Motorized vehicles are prohibited on the paths. This section shall not be interpreted to prohibit the use of boats on the water of Grand Traverse Bay within the riparian extensions of the paths. This section does not prohibit motorized wheelchairs and similar devices. Designated parking does not exist and parking on a shore path is prohibited.

2. Yuba Creek Natural Area:

The Yuba Creek Natural Area is additionally regulated by its management plan: [Yuba Creek Natural Area Management Plan](#)

3. Saylor Park:

Daily boat launch fees apply. Annual boat launch passes are available at the Acme Township Hall. Boat launch fees shall be determined by resolution of the Acme Township Board and maintained on the Township Fee Schedule.

The Saylor Park pavilion is available for rent by contacting Acme Township. Pavilion rental fees shall be determined by resolution of the Acme Township Board and maintained on the Township Fee Schedule.

SECTION 4. Violations and Penalties

Any person who violates any provision of this ordinance shall be responsible for a municipal civil infraction and shall be subject to a fine of not more than \$100.00. Each day this ordinance is violated shall be considered a separate violation. Any action taken under this section shall not prevent civil proceedings for abatement or termination of the prohibited activity.

The Township Zoning Administrator, Township Supervisor, authorized Township Parks employees, Township Manager, and the County Sheriff and his/her deputies are designated as the authorized local officials able to initiate municipal civil infraction actions directing alleged violators of this ordinance to appear in court.

SECTION 5. Nuisance Per Se

A violation of this ordinance is a nuisance *per se*.

SECTION 6. Separate Court Action

In addition to enforcing this ordinance through the use of municipal civil infraction proceedings,

the Township may initiate proceedings in the circuit court to abate or eliminate the violation.

SECTION 7. Validity of this Ordinance and Other Ordinances

If any portion of this ordinance or any application of it is held invalid, the remaining portions or applications of this Ordinance shall continue to be given effect. All prior ordinances in conflict with this ordinance are repealed and shall have no effect.

SECTION 8. Effective Date

This ordinance shall be effective 30 days after being published in the *Traverse City Record Eagle*.

TOWNSHIP OF ACME

By Jay B. Zollinger Date: 7-3-2019
Jay B. Zollinger, Supervisor

By: Cathy Dye Date: 7-3-2019
Cathy Dye, Clerk

WOODLAND ACRES.

Being a portion of Frl. Lot 3 and the SW¹/₄ of SE¹/₄ of all of Frl. Lot 4,
Sec. 27, T. 28 N. R. 10 W. Acme Tp, Grand Traverse County, Michigan.

Examined and Approved

18636

May 25-1924

J. L. Gagnon

Deputy Auditor General

Register's Office
Grand Traverse County
Plat of Woodland Acres
Date Reopened 27th of March A.D. 1924
L.S. in 1921
Chas. Litch, Notary

FILED IN AUDITOR GENERAL'S OFFICE
May 25-1924
J. L. Gagnon
Deputy Auditor General



Description.
The land contained in the annexed plat of Woodland Acres is a portion of Fractional Lot 3, a portion of the SW¹/₄ of the SE¹/₄, and all of Fractional Lot 4, in Sec. 27, T. 28 N. R. 10 W. Acme Township, Grand Traverse County, Michigan, and is more particularly described as follows: -Beginning at an iron stake on the South line of said Section 27, 1048 feet East of the 57th post thereof; Thence N. 12° 45' E., 1455 feet to an iron stake on the South line of Lot 3; Thence N. 30° 35' E., 1653.3 feet to an iron stake on the East line of said Frl. Lot 3; Thence N. 1° 31' E., 121 feet to the North-east corner of said lot; Thence N. 89° 36' W., on the North line of Frl. Lots 4 and 3, 1026.5 feet to the water edge on East shore of Grand Traverse Bay; Thence Southerly 2828.6 feet more or less, following water edge, to the South line of said Section 27; Thence N. 89° 36' E., on said South line 771.6 feet to the point of beginning.

Dedication.
Know all men by these presents, that we Silas J. Gagnon and Sibyl Gagnon, husband and wife, as proprietors, of Traverse City, Mich., have caused the land in the annexed plat to be surveyed and platted, to be known as Woodland Acres, Grand Traverse County, Michigan, said land being a part of Section 27, Township 28 North, Range 10 West, Acme Township, Grand Traverse County, Michigan, as above described, and we hereby dedicate all portions designated on said plat as, Avenues and Paths, to the use of the public.
In witness whereof we hereunto set our hands and seals this 14 day of Feb. 1924 and signed and sealed in presence of
Silas J. Gagnon
Sibyl Gagnon
State of Michigan
County of Grand Traverse

On this 14th day of Feb. 1924 before me a Notary Public in and for said County, personally appeared, Silas J. Gagnon and Sibyl Gagnon, husband and wife, to me known to be the persons who executed the above dedication, and acknowledged the same to be their free act and deed.
Notary Public.
My commission expires July 4-1924

Surveyor's Certificate.
I hereby certify, that the annexed plat of Woodland Acres, Grand Traverse County, Mich., is a correct one, and that monuments consisting of iron pipe (one inch in diameter and two feet or more in length) are driven at points marked 'o' on plat, at all angles in boundary lines, at angles in the center line of streets, at center intersections of streets and at intersection of center lines of streets with boundary lines. At lot corners cedar stakes two inches or more in diameter and eighteen inches or more in length are driven.
C. P. Macomber, Jr. Registrar & Engineer
R. O. Tamm, County Surveyor

Tax Certificate.
Office of County Treasurer, Grand Traverse County, Michigan.
I hereby certify that there are no Tax liens or titles held by the State on the land described in this plat, and that there are no tax liens held by individuals on said lands for the five years preceding the 20th day of March 1924, and that the taxes, for said period of five years, are paid as shown by the records of this office.
John Haggis, County Treasurer

Approval of County Board
This plat approved 20th day of March 1924
Fred J. Haggis, Judge of Probate.
John Haggis, County Treasurer.
S. J. ... County Clerk.

Approval by Township Board.
This plat approved by the Township Board of the Township of Acme, Grand Traverse County, Michigan, at a meeting held March 14th 1924.
Mildred J. ... Township Clerk.
D. ... Deputy



AARP COMMUNITY CHALLENGE

Grants to make communities livable for people of all ages
aarp.org/CommunityChallenge

ATTACHMENT A: APPLICATION

AARP Community Challenge 2020

Grants to make communities more livable for people of all ages

SAMPLE APPLICATION AND BUDGET OUTLINE

All applications must be submitted through the online application at www.aarp.org/communitychallenge by April 1, 2020, 11:59 p.m. ET

NOTE: All fields must be filled out completely in order for the application to be accepted. Please use "n/a" for "not applicable" where appropriate.

BASIC INFORMATION

1. Name of Applicant Organization: _____

2. Amount of this Grant Request: _____

NOTE: AARP reserves the right to award less funds than requested, so applicants should be prepared to discuss how they would scale down their proposals **if asked**.

3. Organization Profile (for non-governmental organizations only, governmental organizations enter n/a).

Brief history of the organization: _____

Has this organization been involved in work to make this a more livable community? If yes, briefly describe and include the issues. _____

4. Organization Address:

Address: _____

City: _____ State: _____ Zip: _____

5. Organization Tax Status: Please check the one that best applies:

- 501(c)(3) NONPROFIT
- 501(c)(4) NONPROFIT
- 501(c)(6) NONPROFIT
- A MUNICIPALITY
- ANOTHER UNIT OF GOVERNMENT
- OTHER (PLEASE DESCRIBE) _____

6. Organization Twitter Handle: _____
(if none, enter n/a)**7. Organization Facebook Name:** _____
(if none, enter n/a)**8. Did your organization apply for a grant in 2017, 2018 or 2019?**

- Yes – Selected more than once
- Yes – Selected once
- Yes – Not selected
- No – did not apply

9. How did you hear about this grant opportunity?

- The AARP State Office in my state
- The AARP Livable Communities e-newsletter
- An organizational newsletter or conference
- 880 Cities
 - American Planning Association or State Association of Planners
 - American Society for Landscape Architects
 - America Walks
 - Congress for New Urbanism
 - Federal or State Government Agency
 - Land Trust Alliance
 - League of American Bicyclists or local bike/ped advocacy organization
 - LOR Foundation
 - Metrolab
 - National League of Cities or State League of Cities/State Municipal League
 - National or State Association of Counties
 - National Main Street Center or local Main Street Organization
 - Rails to Trails
 - Smart Growth America
 - Strong Towns

- Trust for Public Land
- Other
- A local event or newsletter
- Word of mouth in the community
- Social Media
- Other

POINTS OF CONTACT

10. Grant Application Contact:

Name: _____

Title: _____

Address: _____

Phone: _____ Email: _____

11. Project Implementation/Execution Point of Contact (if different from #10):

Name: _____

Title: _____

Address: _____

Phone: _____ Email: _____

COMMUNITY DETAILS

12. Name of Municipality Where Project Will Be Physically Located/Delivered:

13. Approximate Address Where this Project Will Be Delivered:

NOTE: This information is for AARP's analysis purposes only and will not be used in award information, etc.

Address: _____

City: _____ State: _____ Zip: _____

14. Approximate population for the city/town/area where this project will be delivered:

NOTE: Please do not enter population ranges.

15. Would you describe this community as:

- Rural
- Suburban
- Urban

PROJECT DETAILS

16. Project Summary:

Please provide a summary of your project in 2,000 characters or less.

NOTE: This grant may NOT be used for the following activities:

- Partisan, political or election related activities
- Planning activities and/or assessments and surveys
- Studies with no follow-up action
- Publication of books or reports
- The acquisition of land and/or buildings
- Solely to sponsor other organizations' events or activities
- Research and development for a nonprofit endeavor
- Research and development for a for-profit endeavor
- The promotion of a for-profit entity and/or its products and services

17. Project Livability Improvement Statement:

Please specify in 350 characters or less the social impact this grant will bring to the community, especially to individuals aged 50-plus.

For example: This grant will improve (COMMUNITY X) by enhancing public safety through improving the walkability of the area for older residents and all individuals by adding traffic calming elements.

Please see additional examples in Attachment D.

18. Project Category:

Please select the category below that best describes your project, along with the *primary* corresponding sub-category.

- Create vibrant public places** in the community through permanent or temporary solutions that improve open spaces, parks and access to other amenities.
- Public space activation (e.g., public plaza improvements, parklets, street trees, alleyway activation, seating and games in public spaces, seating along Main Street corridors, signage in neighborhoods)
 - Public art installations that make a space more inviting (e.g. murals and sculptures that are connected to a broader plan for the public space)
 - Park enhancements (e.g., park equipment improvements, new structures, dog parks)
 - Playgrounds (e.g., intergenerational play spaces)
 - Community gardens (e.g., building accessible community garden beds)
 - Activities to engage people in vibrant public places (e.g., open streets events)
 - Accessibility of amenities (e.g., increasing accessibility features of park equipment)
 - Public safety interventions (e.g., proper lighting, landscaping, block revitalization/maintenance)
 - Other (please only select if your project does not fit into one of the above categories and please describe in detail)
-
- Deliver a range of transportation and mobility options** through permanent or temporary solutions that increase connectivity, walkability, bikeability and access to public and private transit and safety.
- Roadway/sidewalks/crosswalk improvement and beautification (e.g., markings for crosswalks, traffic calming pop-ups at intersections)
 - Micro-mobility enhancements/management (e.g., parking and training on scooters, e-bikes, etc.)
 - Bikeability (e.g., bike sharing options, temporary bike lanes)
 - Expansion and enhancement of existing transportation options (e.g., adding volunteer-led transportation programs, enhanced coordination of existing transportation resources)

- Public or private transit access and safety (e.g., transit shelters, activating and improving transit stops)
 - Improved wayfinding (e.g., signage and markings)
 - Trails (e.g., completing and connecting trails, signage)
 - Accessibility of transportation amenities (e.g., increasing accessibility features of transportation options for people of all abilities, including ADA compliance, etc.)
 - Other (please only select if your project does not fit into one of the above categories and please describe in detail)
-

- Support the availability of a range of housing** in the community through permanent or temporary solutions that increase accessible and affordable housing options.
- Accessory dwelling units and tiny homes
 - Co-housing programming and resources
 - Resources about housing options and available services
 - Innovative or new home maintenance, repair and support services
 - Lifelong housing and accessibility
 - Other (please only select if your project does not fit into one of the above categories and please describe in detail)
-

- Increase civic engagement with innovative and tangible projects** that bring residents and local leaders together to address challenges and facilitate a greater sense of community inclusion and diversity.
- Developing projects based on residents' priorities (e.g., participatory budgeting efforts)
 - Bringing resident insight and volunteer power into local government (e.g., citizen academies, local volunteers supporting City Hall efforts)
 - Engaging residents alongside thought leaders in problem solving (e.g., hackathons)
 - Other ideas that improve civic engagement in the community (please only select if your project does not fit into one of the above categories and please describe in detail)

Note to Nonprofits: While this new category is targeted to local governments, nonprofits can still apply for and receive a grant in this category, but they must demonstrate that they are working with local governments to solicit and include citizen expertise on the project or to help solve a pressing community challenge.

- Demonstrate the tangible value of “Smart Cities”** by developing and implementing innovative programs that involve residents in accessing, understanding and using data to engage in decision-making that increases quality of life for all.
 - Tools and programming to capture data and resident feedback
 - Activities that highlight the use of data to improve decision-making in local government
 - Other (please only select if your project does not fit into one of the above categories and please describe in detail)

- Other**
 - Connectivity improvements, including broadband access.
 - Activities that increase access to healthcare services
 - Activities that support family caregivers
 - Activities to support entrepreneurship and economic development
 - Other (please only select if your project does not fit into one of the above categories and please describe in detail)

19. Project Deliverables:

Please specify the individual deliverables. Provide as much detail as you can about any **physical structures** (such as benches, lighting, signage, etc.), **dates, addresses** and **communications** within 300 characters for each deliverable. See examples in Attachment D.

Deliverable 1: _____

Deliverable 2: _____

Deliverable 3: _____

Deliverable 4: _____

Deliverable 5: _____

Add more as necessary

For example:

- I. Provide suitable lighting in the public space located at (ADDRESS) between Street X and Street Y.
- II. Commission and install ten (10) structures with LED lighting at (ADDRESS) with custom side panels.
- III. Install four (4) benches at (ADDRESS).
- IV. Install signage at (ADDRESS)
- V. Conduct outreach to the community through local media and social platforms owned by the City, Main Street Organization and the Chamber of Commerce and will include at least three (3) published communications promoting the public space improvements.

20. Project Type:

PLEASE NOTE: Proposals for the project types described below will be prioritized over those that support ongoing programming or events.

- Permanent physical fixtures in the community
- Temporary demonstrations that lead to long-term change
- New, innovative programming or services

PROJECT NARRATIVE AND BUDGET

Please complete each section with 2,000 characters or fewer (excluding Question 27)

21. Livable Communities Activities. Please provide a brief summary of the ongoing efforts to make this community more livable for all ages and share how the Community Challenge project will support that effort and have a lasting impact.

22. Community engagement. Please describe how residents and local organizations been engaged in the area’s livable communities activities to date. How will you engage the community and involve older adults in the process as you execute this grant?

23. Role of Volunteers. Please describe how residents and local organizations been engaged in the area’s livable communities activities to date. How will you engage the community and involve older adults in the process as you execute this grant?

a. Do you anticipate volunteers age 50 and older playing a role in the implementation of the Community Challenge project?

Yes

No

b. Please describe the role that volunteers (particularly those 50+) will play in implementing the Community Challenge project.

24. Multicultural Population. If the primary beneficiaries of this project are from a multicultural population, please select the one or two populations who are primarily served below (Please note: This does not carry weight in the scoring criteria).

African American/Black

Hispanic/Latino

Asian American Pacific Islander

Native American

LGBT

Other, please describe: _____

25. Metrics. Fill in the table with the estimated metrics you will be able to capture over the course of this grant activity and beyond, and include goals for each metric. *For example: number of people served, number of certifications issued, structures achieving ADA-compliance, etc.*

| Metric | Goal |
|---|---------------------------------------|
| <i>Example: Number of People Served</i> | <i>Example: 50 Individuals Served</i> |
| (text) | |
| (text) | |
| (text) | |
| (text) | |
| (text) | |
| (text) | |

26. Matching Funds and In-Kind Support. Matching funds are not required. However, please detail any matching funds or in-kind support the organization will receive to contribute toward this project.

| | Matching Funds (\$) | In-Kind Support |
|-----------|---------------------|-----------------|
| Nonprofit | | |
| Private | | |
| Public | | |

27. Project Budget. Please specify what expenses will be covered by the grant. Itemize anticipated expenses and income (if any) for this proposal. Include in-kind services, such as donated materials and/or labor. Add explanations if necessary.

| | Expense | Additional information |
|--|---------|------------------------|
| Contracted services costs | | |
| Staff costs, if any | | |
| Office materials & supplies, if any | | |
| Travel expenses, if any | | |
| TOTAL REQUESTED | | |
| Are there matching funds or services planned? What is their value? | | |

28. How will you use AARP branding?

29. Other Funding: AARP might be contacted by other potential funders that could be interested in funding projects that were not granted through the AARP Community Challenge. The potential funders may have additional process steps and funding requirements than those of the AARP Community Challenge. If requested, AARP would like to send your contact information, organization name and a short description of your proposal, including the community where the project would take place (“Project Information”). Please note that these projects will be subject to any potential funder’s own terms, conditions and review. Please indicate in your application whether or not you give permission to AARP to share your contact information and a description of your proposal. If you select “yes,” you agree on behalf of yourself and your organization to release AARP from all liability associated with sharing the Project Information with potential funders. We will alert you before this information is given to potential funders.

Do you give AARP permission to share this information with other organizations that might be interested in funding your project?

YES

NO

An Opportunity for Other Possible AARP Funding: Please note that by submitting a proposal for the AARP Community Challenge initiative, you and your organization give AARP permission to reach out to you and others at your organization about other possible AARP funding opportunities that your proposal may be eligible for based on the AARP Community Challenge criteria. However, please note that AARP is not obligated in any way to consider your proposal for any additional AARP funding.

NOTIFICATION

Successful applicants will be notified by email. In order to receive funding, selected applicants must execute and return a binding Memorandum of Understanding and completed financial forms to the AARP National office to communitychallenge@aarp.org by 11:59 p.m. June 29, 2020. Noncompliance with this time period may result in disqualification.